

Casters for Aluminum Extrusions

Double Wheels Swivel / Screw-in

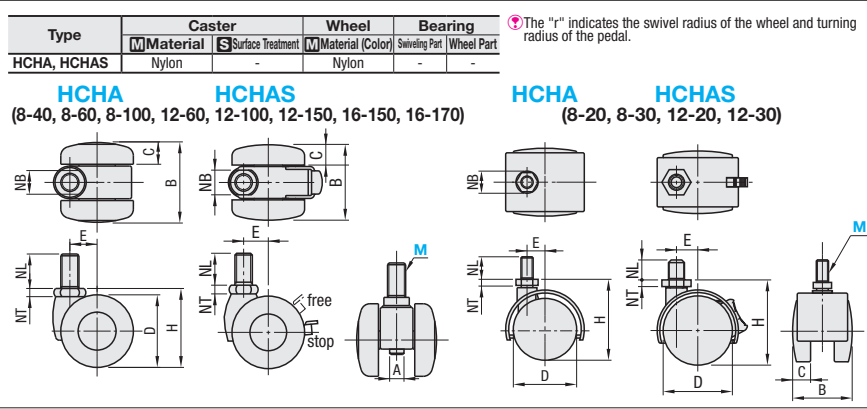

Body Type	Part Number Type	M (Coarse)	Allowable Load		D	H	A	B	C	E	NB	NT	NL	HCHA		HCHAS	
			(kgf)	(N)										Unit Price	Volume Discount Rate	Unit Price	Volume Discount Rate
HCHA HCHAS (With Stopper)	8	8	20	196	40	50	-	41	13	15	13	4	15				
			30	294	40	43.5	7	44	12	15	14	4.5	12				
			40	396	40	43.5	7	44	12	15	14	4.5	12				
			60	594	50	57.5	8	49	14	17	17	6	14				
			100	990	60	68.5	8	49	14	17	17	6	14				
			120	1485	75	84.5	10	59	17.5	22	22	8	25				
	12	12	20	196	40	50	-	41	13	15	19	4	15				
			30	294	40	43.5	7	44	12	15	18	4	15				
			40	396	40	43.5	7	44	12	15	18	4	15				
			60	594	50	57.5	8	49	14	17	17	6	14				
			100	990	60	68.5	8	49	14	17	17	6	14				
			150	1485	75	84.5	10	59	17.5	22	22	8	25				
16	16	150	1485	75	84.5	10	59	17.5	22	22	8	25					
		170	1683	75	84.5	10	59	17.5	22	22	8	25					

Ordering Example: Part Number - W
HCHA12 - 100

Days to Ship: [Configure Online](#)

Mounting
Turn the hex screw head at the lower part of wheel, (the part shown with A) then the upper thread part of screw will turn. Tighten by the flats shown as NB.
For * marked types, install and tighten the NB part with a wrench.

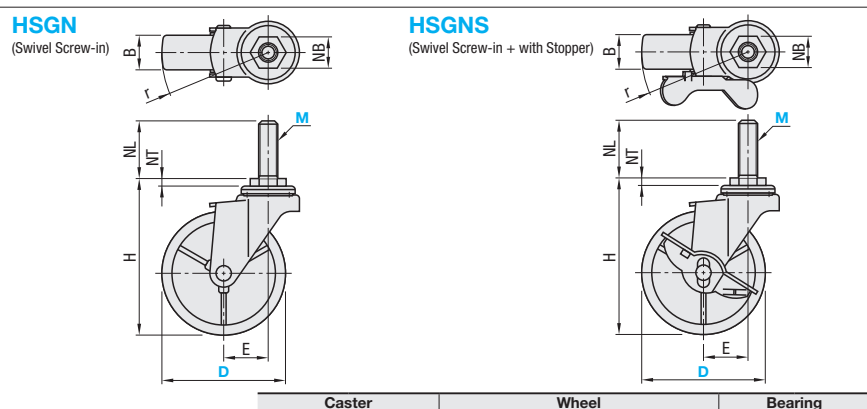

Body Type	Part Number Type	M (Coarse)	Wheel Material	Wheel Width B			E	NB	NT	NL	r	Allowable Load (N)			Mass (g)			Unit Price				
				H	R	U						N	R	U	N	R	U	N	R	U	N	
Swivel Screw-in Type	HSGN	50	8	R (Rubber) U (Urethane) N (Nylon)	68	20	21	21	22	14	14	47	380	400	195	175	165					
		65	12		85	21	21	21	23	19	4.8	56	400	270	220	210						
		75	12		95	21	21	21	27		35	65	400	450	500	310	240	225				
		100	12		126	25	28	25	31	21	4	40	82	500	600	600	585	435	405			
		120	16																			
Swivel Screw-in With Stopper Type	HSGNS	50	8	R (Rubber) U (Urethane) N (Nylon)	68	20	21	21	22	14	14	49	300	380	220	200	190					
		65	12		85	21	21	21	23	19	4.8	57	300	400	305	255	235					
		75	12		95	21	21	21	27		35	65	400	450	500	340	275	250				
		100	12		126	25	28	25	31	21	4	40	82	500	600	600	650	620	585			
		120	16																			

Ordering Example: Part Number - M - Wheel Material
HSGN75 - 12 - U

Days to Ship: [Configure Online](#)

Price: [Configure Online](#)

Casters for Aluminum Extrusions / Side Mount Caster Brackets / Foot Mount Brackets

Rubber Wheel Type

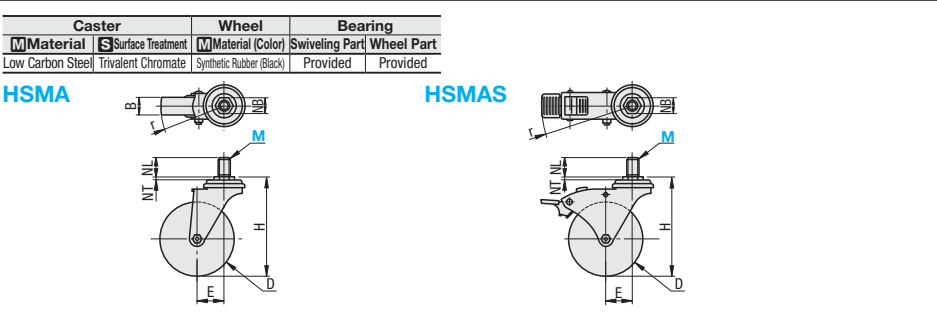

Body Type	Part Number Type	M (Coarse)	Allowable Load		D	H	B	E	NB	NT	NL	r	Mass (g)	Unit Price
			(kgf)	(N)										
Swivel	HSMA	12	60	594	75	105	25	30	23	4	25	72	500	
		16	70	695	100	137	35	35				89	700	
Swivel with Stopper Type	HSMAS	12	60	594	75	105	25	30	23	4	25	105	640	
		16	70	695	100	137	35	35				128	950	

Ordering Example: Part Number - W
HSMA16 - 70

Days to Ship: [Configure Online](#)

Price: [Configure Online](#)

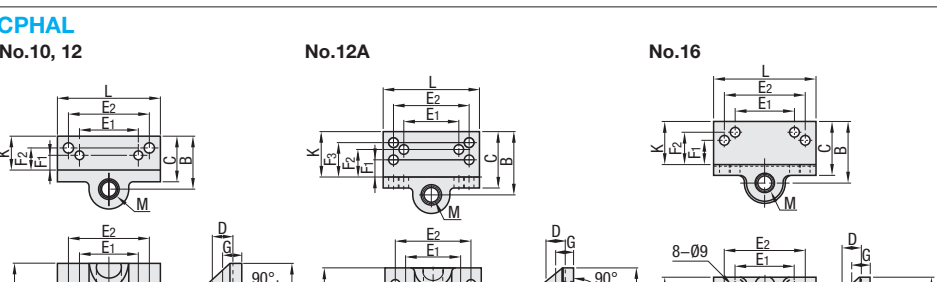
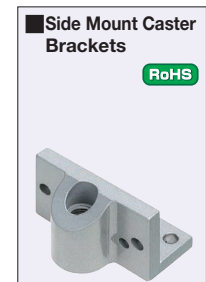

For mounting hole configurable type, see P:1018

Material: Aluminum Casting Alloy 383.0 Surface Treatment: Baked Finish (Silver)

Part Number Type	No.	Extrusion	M (Coarse)	H	L	B	K	C	T	D	G	Mounting Hole Dimension			Mass (g)	Unit Price	Volume Discount Rate
												E1	E2	F1			
CPHAL	10	20 / 30 Square	10	45	70	36	23	31	8	14	13	40	55	10	15	135	
	12	25 Square / 40 Square / 50 Square	12	45	70	46	33	41	8	14	13	40	55	12.5	20	165	
	12A	25 Square / 40 Square / 50 Square	12	45	70	46	33	41	8	14	13	40	55	12.5	20	165	
	16	45 Square / 60 Square	16	50	95	57	40	50	10	20	17	55	75	22.5	30	285	

Ordering Example: Part Number
CPHAL10

Days to Ship: [Configure Online](#)

Example: [Mounting of Caster](#) [Mounting of Leveling Mount](#)

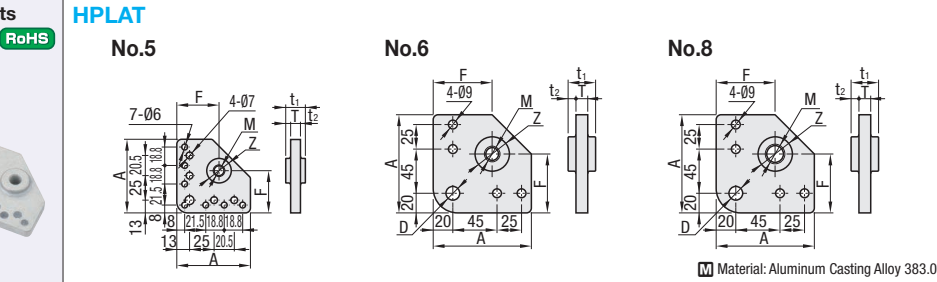

Part Number Type	No.	Extrusion	A	T	M	Z	D	F	t1	t2	Mass (g)	Unit Price	Volume Discount Rate
HPLAT	5	20 / 30 Square	75	10	12	25	-	43	20	5	120		9-20
	6	40 Square	100	12	16	35	14	60	28	8	281		
	8	40 Square	100	12	20	35	14	60	28	8	273		

Ordering Example: Part Number
HPLAT6

Days to Ship: [Configure Online](#)