

TAPERLESS ONE-STEP CORE PINS (NO DRAFT ANGLE CORE PINS)

—SHAFT DIAMETER(D)SELECTION TYPE—

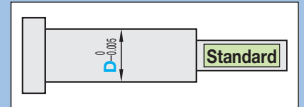

Non JIS material definition is listed on P.1359 - 1360

RoHS	M H	Part Number		
		Type	Step	Shape
	SKD61 equivalent 48~52HRC	CPPS—	B	S
	SKH51 equivalent 58~60HRC	CPHS—		C
	NAK80 37~43HRC	CPKS—	D	T
	SUS440C 56~60HRC	CPWS—	E	R

Step (Step type) Select from B~E in the drawing below.

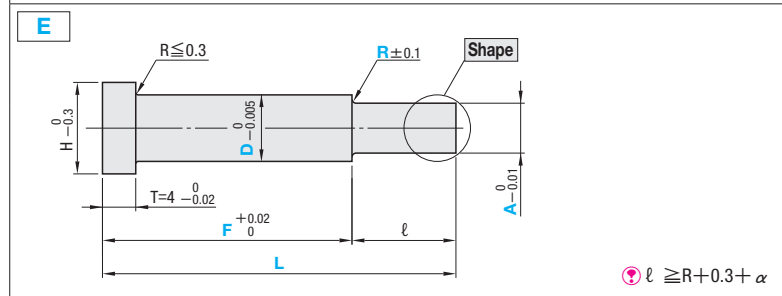
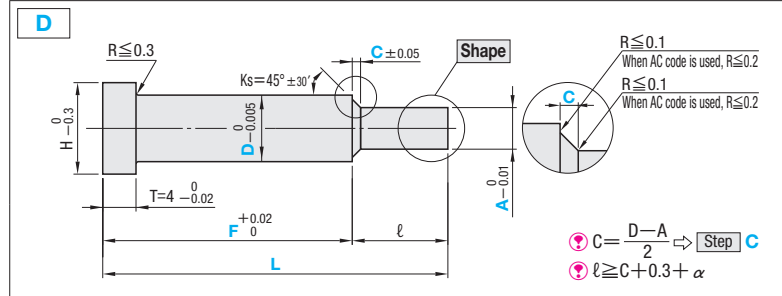
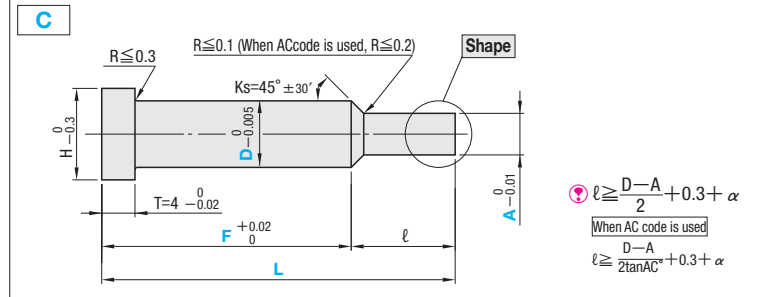
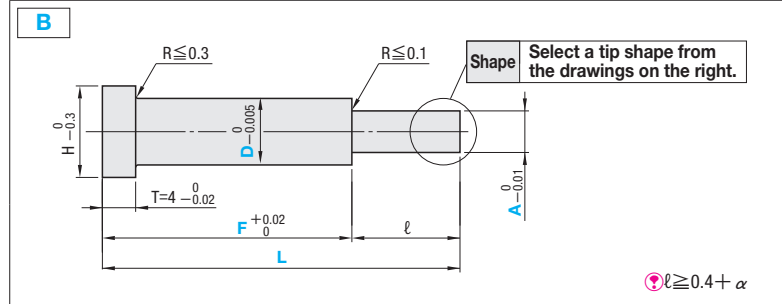

Shape (Tip shape)

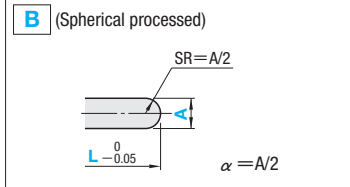
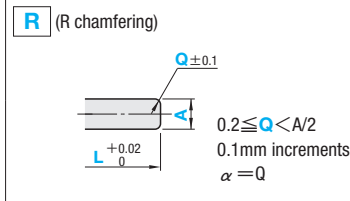
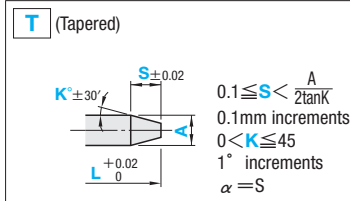
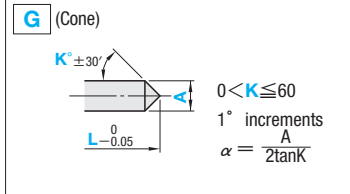
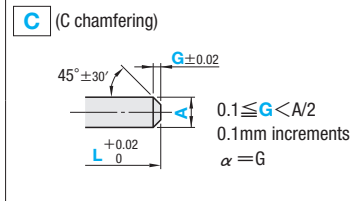
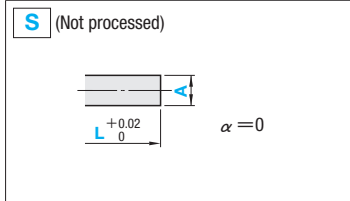

H	Part Number				0.01mm increments				0.1mm increments		ℓ max.													
	Type	Step	Shape	D	L min.	L max.	F min.	F max.	A min.	A max.		C	R											
3	CPPS— CPHS— CPKS— CPWS— (D ≤ 16)	B	C	1	12.00	100.00	10.00	L-ℓ	min.	D > A	Only [Step] D is designated.	Only [Step] E is designated.												
4				1.5									0.50											
5				2																				
6				2.5																				
7				3																				
8				3.5																				
9				4																				
10				4.5																				
11				5																				
15				5.5																				
18				6																				
21				6.5																				
25				7																				
																8	CPHS only	28.00	min.	Refer to [Step] drawing	2.00	D > A	C < $\frac{D-A}{2}$ and 0.1 ≤ C ≤ 4.0	R ≤ $\frac{D-A}{2}$ and R ≥ 0.2
																9								
																10								
				15																				
				16	150.00	5.00																		

Order

Part Number	L	F	A	C · R	Tip size (K · S · G · Q)
CPPS—BS4	45.55	F40.00	A3.50		G1.0
CPHS—CC6	52.30	F42.50	A4.60		K30
CPWS—DG5	48.62	F37.55	A4.00	C0.2	Q0.5
CPKS—ER6.5	55.65	F42.35	A4.50	R0.5	

Days to Ship

3 Days

Express T Express A

P.46

Price

Quantity discount rate P.45

Quantity	Rate
1~4	5%
5~12	10%
13~19	15%
20~50	15%

Alterations

Part Number	L	F	A(AAC)	C(CVC) · R(RE)	K · S · G · Q	(K · WKC...etc.)
CPPS—DC6	65.00	F55.00	A3.50	C0.5	G0.5	KC3.0—TC3.0
CPHS—DS5	50.00	F38.00	A2.00	C0.3		TRN

Alteration details P.497

Alterations	Code	Spec.	1Code	Alterations	Code	Spec.	1Code
	KC	Single flat cutting D/2 ≤ KC < H/2			TC	Head thickness change TC=0.1mm increments 1.5 ≤ TC < 4 (Dimensions L and F remain unchanged) 4—TC ≤ Lmax.—L	
	WKC	Two flats cutting D/2 ≤ WKC < H/2			TRN	Relief under the head (Makes plate chamfering unnecessary)	
	KAC KBC	Varied width parallel flats cutting D/2 ≤ KAC < H/2 KBC=0.1mm increments only KAC < KBC < H/2			NHC	Numbering on the head How to order P.498 Available when H ≥ 2 Combination with SKC not available. Express services not available.	
	RKC	Two flats (right angled) cutting D/2 ≤ RKC < H/2			RE	R shape alteration (enlargement) RE=0.5mm increments 0.5 ≤ RE ≤ 2.0 F tolerance is +0.05 Available for [Step] E	
	DKC	Three flats cutting D/2 ≤ DKC < H/2			CVC	C dimension can be designated at 0.01mm increments. 0.10 ≤ CVC ≤ 1.00 CVC=0.01mm increments Available for [Step] D	
	SKC	Four flats cutting D/2 ≤ SKC < H/2			AAC	Extends the working limit of A min. AAC = 0.01mm increments ℓ ≤ 10 × AAC CPKS is available when D ≥ 3.5	
	KGC	Two flats (angled) cutting D/2 ≤ KGC < H/2 0 < AG < 360 AG=1° increments			AC	Changes the standard angle (Ks=45°). AC=1° increments Available for [Step] C · D 30 ≤ AC ≤ 60 When [Step] D, C ≤ 1.0, A + 2 (C × tan AC) < D	
	KTC	Three flats cutting at 120° D/2 ≤ KTC < H/2			GVC	Gas vent machining GS · GB=1mm increments Available when D ≥ 2 2 ≤ GS ≤ 10 GS+2 ≤ GB ≤ 30 F min. ≤ F—GB How to order P.498	
	HC	Head diameter change HC=0.1mm increments D ≤ HC < H In relation to the diameter tolerance, alteration may create a straight piece with little diameter difference between the head and shaft.					
	HCC	Head diameter change (precision) HCC=0.1mm increments D+0.5 ≤ HCC < H—0.3					

For details of a Gas Release Core Pin with Gas Vent, which is a product similar to alteration GVC P.513