

Magnetic Catches with Sensors / Door Limit Switches

Reduced
Days to Ship

Door Limit Switches

BCWS

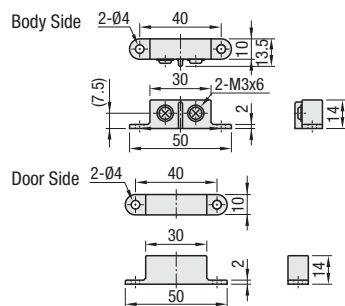

Wiring

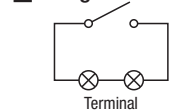

Performance

Detection Distance	As Shown Below	Part Name	Material
Max. Operating Voltage	DC100V	Main Body	ABS Resin
Max. Operating Current	0.5A	Magnet	Ferrite
Max. Operating Power	10W	Terminal	304 Stainless Steel
Contact Resistance	150mΩ		
Withstand Voltage	DC200V 1min		

AC Unusable



Example

Detection Range

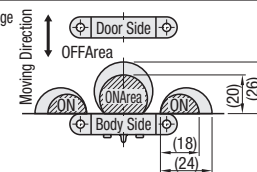

Part Number	Mass (g)	Unit Price	Volume Discount Rate
Type	No.	1~9 pc(s).	10~
BCWS	1	19	

Part Number
BCWS1

Configure Online

Terminal Type

MGST



No.	Part Name	Material	Surface Treatment
①	Main Body	Polybutylene terephthalate (PBT)	-
②	Terminal Cover	Polycarbonate	-
③	Back Plate	Low Carbon Steel	Nickel Plating

Part Number	Operation	Retention Force (kgf)	Case Color	Mass (g)	Unit Price	Volume Discount Rate
Type	No.	1~4 pc(s).			1~4 pc(s).	5~
MGST	1	OFF when attracted	3	Gray	52	
	2	ON when attracted				

Part Number
MGST1

Configure Online

Performance - Overview

Electrical Performance	Insulation Resistance (Initial)	100MΩ or More (with 500VDC Insulation Resistance Meter)	Service Life	Mechanical Life	100,000 Times or More (Open/Close Frequency: 60 times/min.)	Operating Temperature	-20~+80°C (No Freezing)
	Withstand Voltage	Between Contact Points: 1,000VAC/min. (Initial) Between Each Terminal and Non-charging Metal Part: 2,100VAC/min. Between Each Terminal and Ground: 2,100VAC/min.	Electrical Life	Electrical Life	30,000 Times or More (Resistance Load 250VAC, 5A) Open/Close Frequency: 20 times/min. 30,000 Times or More (Lamp Load 125VAC, 15A)	Operating Conditions	95% RH or Less
			Degree of Protection		IP40	Allowable Operating Frequency	Mechanical: 60 times/min., Electrical: 20 times/min.

3 Wire Magnetic Catches

HMGR-T

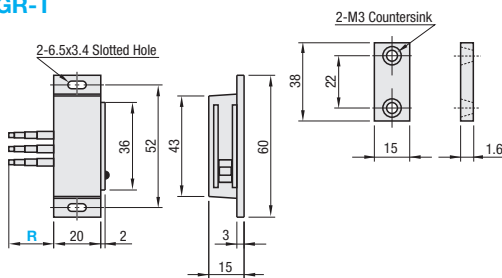

Part Number	Retention Force (kgf)	Mass (g)	Unit Price	Volume Discount Rate
Type	R		1~9 pc(s).	10~
HMGR-T	150	2	43	
	2000			

The default R dimension is 150 unless specified.

Part Number
HMGR-T - 150

Configure Online

Magnetic Catches with Sensors / Ball Catches

Wire Connection Type

RoHS

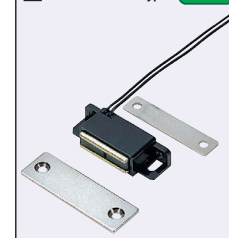

No.	Part Name	Material	Surface Treatment
①	Main Body	Polycarbonate	-
②	Catch Plate	Low Carbon Steel	-
③	Back Plate	Steel	Nickel Plating

MGSR

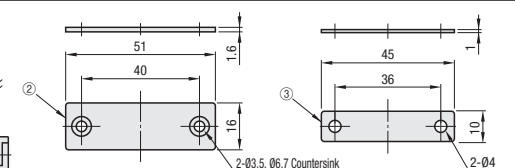
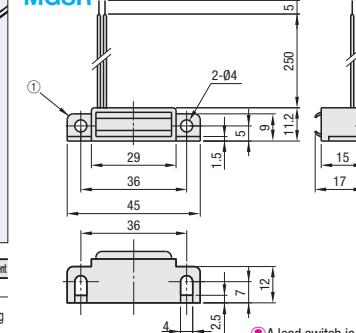

Performance

Maximum ON/OFF Power	10W
Maximum ON/OFF Voltage	100V DC
Maximum ON/OFF Current	0.5A DC
Maximum Contact Resistance	0.15Ω *1
Operating Temp. Range	0~60°C
Lead Wire	UL1007 AWG#26 / Black
Lead Wire Tensile Strength	1kgf

*1: Lead wire conductor resistance is excluded.

Part Number	Operation	Retention Force (kgf)	Mass (g)	Unit Price	Volume Discount Rate
Type	No.			1~4 pc(s).	5~
MGSR	1	OFF when attracted	3	28	
	2	ON when attracted			

Part Number
MGSR2

Configure Online

Caution

- Do not apply any strong impacts since a lead switch is used.
 - Do not use or store in places with strong magnetic fields.
 - Carefully keep magnetic materials (particles) and adhesive objects and etc. away from the attraction surface of the product.
- To mount it on a nonmagnetic object (wood, plastic, glass, aluminum, etc.), mount the included back plate or a similar magnetic object on the mounting surface.

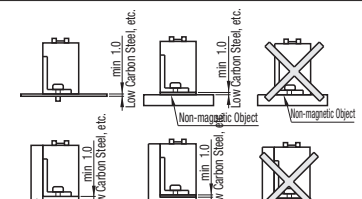

Magnetic Catches with Switch

RoHS



MGSTK

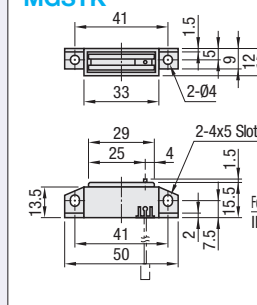

There is no catch plate.

Performance

Circuit Type	1 Circuit, 1 Contact, Normally Closed
Rating	30VDC 10mA (Resistive Load)
Maximum ON/OFF Voltage	500VAC/min.
Maximum Contact Resistance	100MΩ or More (500VDC)
Operating Temp. Range	-10°C~+70°C
Lead Wire	For IL-G of Japan Aviation Electronics
Lead Wire Tensile Strength	1kgf

Part Name	Material	Surface Treatment
Main Body	Polypropylene	-
Magnet	Ferrite	-

Part Number	Retention Force (kgf)	Case Color	Mass (g)	Unit Price	Volume Discount Rate
Type				1~9 pc(s).	10~49
MGSTK	3	Black	13		50~

Part Number
MGSTK

Configure Online

Ball Catches

RoHS



BCAS (Stainless Steel)

BCASS (Stainless Steel)

BCASD (Zinc Die Cast)

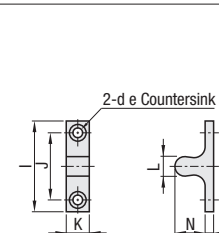
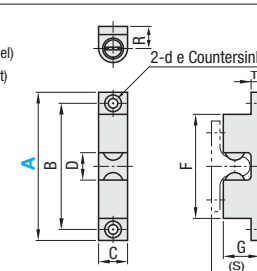

Type	Material	Surface Treatment
BCAS	316 Stainless Steel	-
BCASS	304 Stainless Steel	-
BCASD	Zinc Die Cast	Chrome Plating

Part Number		B	C	D	d	e	F	G	T	I	J	K	N	L	R	(S)	Latching Force N (kgf)	Unlatching Force N (kgf)	Mass (g)	Unit Price		
Type	A																			BCAS	BCASS	BCASD
BCAS BCASS BCASD	32	25	8	4	3.2	6.2	18	9	2	18	11	8	6.5	3.2	6	11.5	17(1.7)	8(0.8)	12			
	43	35	8	5.9	3.2	6.2	28.4	10	2.5	25	16	7.5	8.5	4.5	6	13.5	20(2)	13(1.3)	16			
	50	40	10	7.5	4.2	8.2	31.5	12.2	2.9	30	20	9	10.3	6	7.7	15.9	23(2.3)	18(1.8)	28			
	70	60	13	13			51	17	4	42	30	10.5	15	10	10.5	23	56(5.7)	38(3.9)	78			

Part Number
BCAS50

Configure Online



Configure Online