

CORE PIN BLANKS

Non JIS material definition is listed on P.1351 - 1352

Straight Core Pins

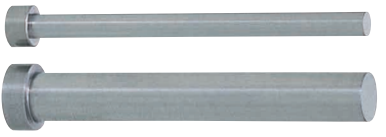

RoHS

Part Number	M	H	T D
CPD	SKD61 equivalent	48~52HRC	-0.01 -0.02
CPH	SKH51 equivalent	58~60HRC	0 -0.005

Order

Part Number	-	L
CPD6	-	60

Days to Ship

Quotation

Price

Quotation

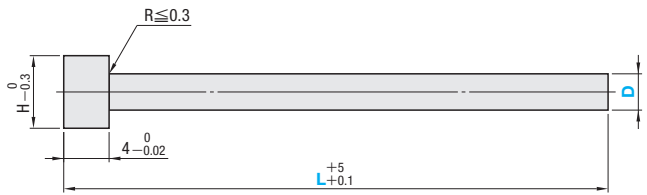

H	Part Number		L
	Type	D	
3		1	60
		1.1	
		1.2	
		1.3	
		1.4	
		1.5	
4	CPD (SKD61 equivalent)	1.6	60
		1.7	
		1.8	
5	CPH (SKH51 equivalent)	1.9	100
2			
2.5			
3			
3.5			
4			
4.5			
5			
5.5			
6			
6.5			
7			
8			
10		10	
11		11	
15		15	
18		18	